

Twinspect

High-performance asset inspections
– from anywhere, at any time.

The powerful and unique visual intelligence technology of TWINSPECT radically improves the way you inspect and maintain physical infrastructure in the future. This technology assists human experts in doing their jobs – detecting and analyzing structural defects and helping them make the right decisions when it matters.

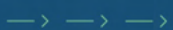

From anywhere at any time.

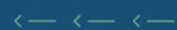

Key Features

Photorealistic 3D Reality Models

Visualize, share and analyze highly detailed photogrammetry 3D models, from leading brands such as Metashape, ContextCapture, RealityCapture, and DJI Terra - without any quality loss, in highest resolution.

Georeferenced 3D Models

Upload models with accurate spatial information for precise alignment and the ability to view your model's location, related images, annotations, and AI detections in our project map space.

AI-assisted Defect Detection

Powerful, state-of-the-art deep learning AI models help experts to analyze RGB images and 3D reality models to build your own AI model based on your detection needs.

High-Res Drone Inspection Imagery

Manage, share and analyze the high-res original inspection images in sync with the 3D reality models. In this way, we help expert teams to keep up with their existing workflows.

Customizable Annotations

Inspection teams can define custom annotation templates with their own attributes, fields and registrations to support various registration formats and inspection norms.

Detailed Inspection Reports

Automatically generate inspection reports in various formats that contain all relevant annotations and measurements, as well as all high-res images and overviews.

Annotation and Measurement Tools

Tag and measure defects and other registrations directly in 3D reality model or on the original images. All registrations will be synchronized and tagged on all images and in the 3D models.



Twinspect Lite

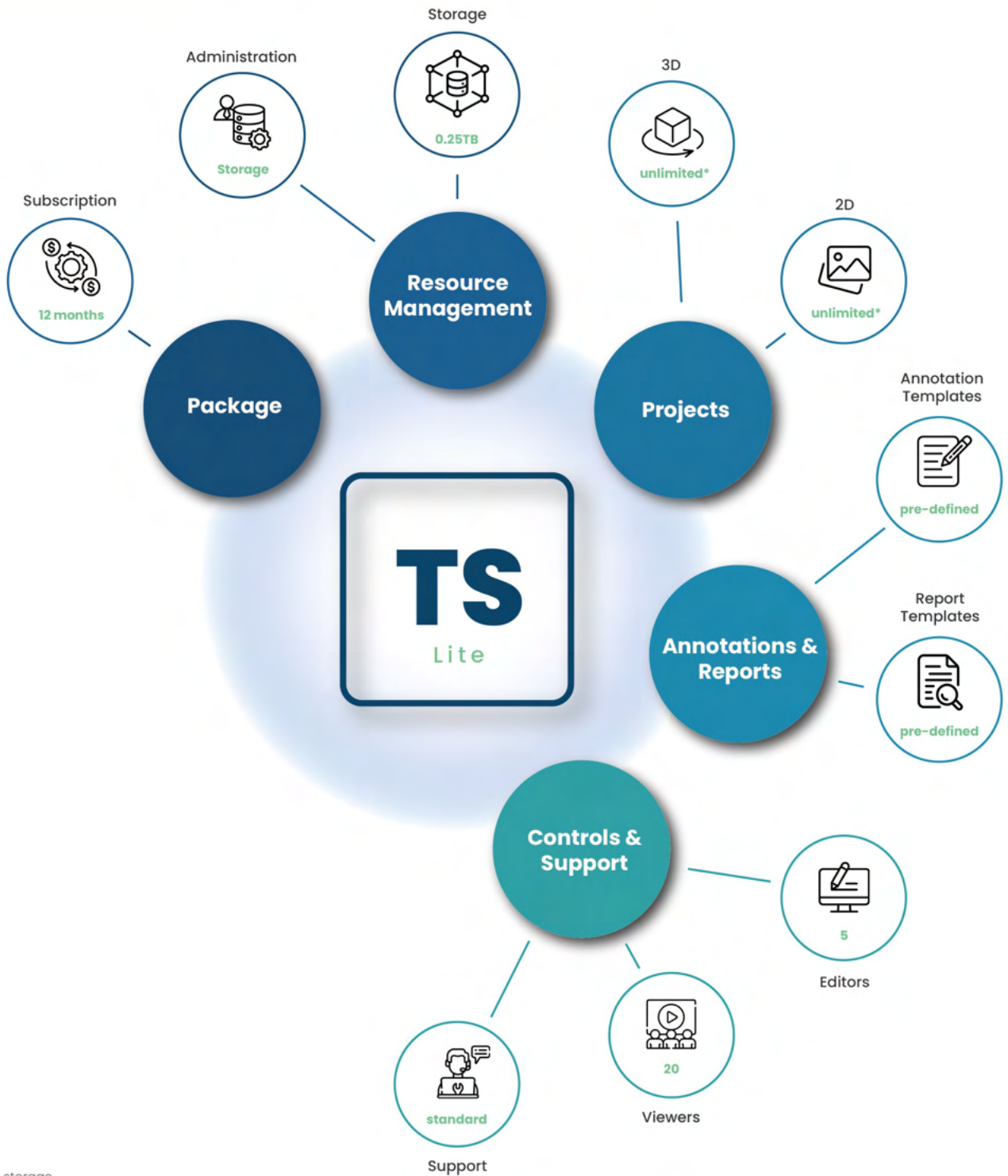

*to available storage

Small Business Flexibility

Get started with Twinspect Lite, the ideal solution for individuals and small teams seeking essential inspection capabilities. Enjoy user-friendly storage management, pre-defined annotation tools, and convenient report templates that simplify your inspection processes. Perfect for those who need reliable functionality to help you achieve efficiency and accuracy in your daily operations.

Twinspect Pro

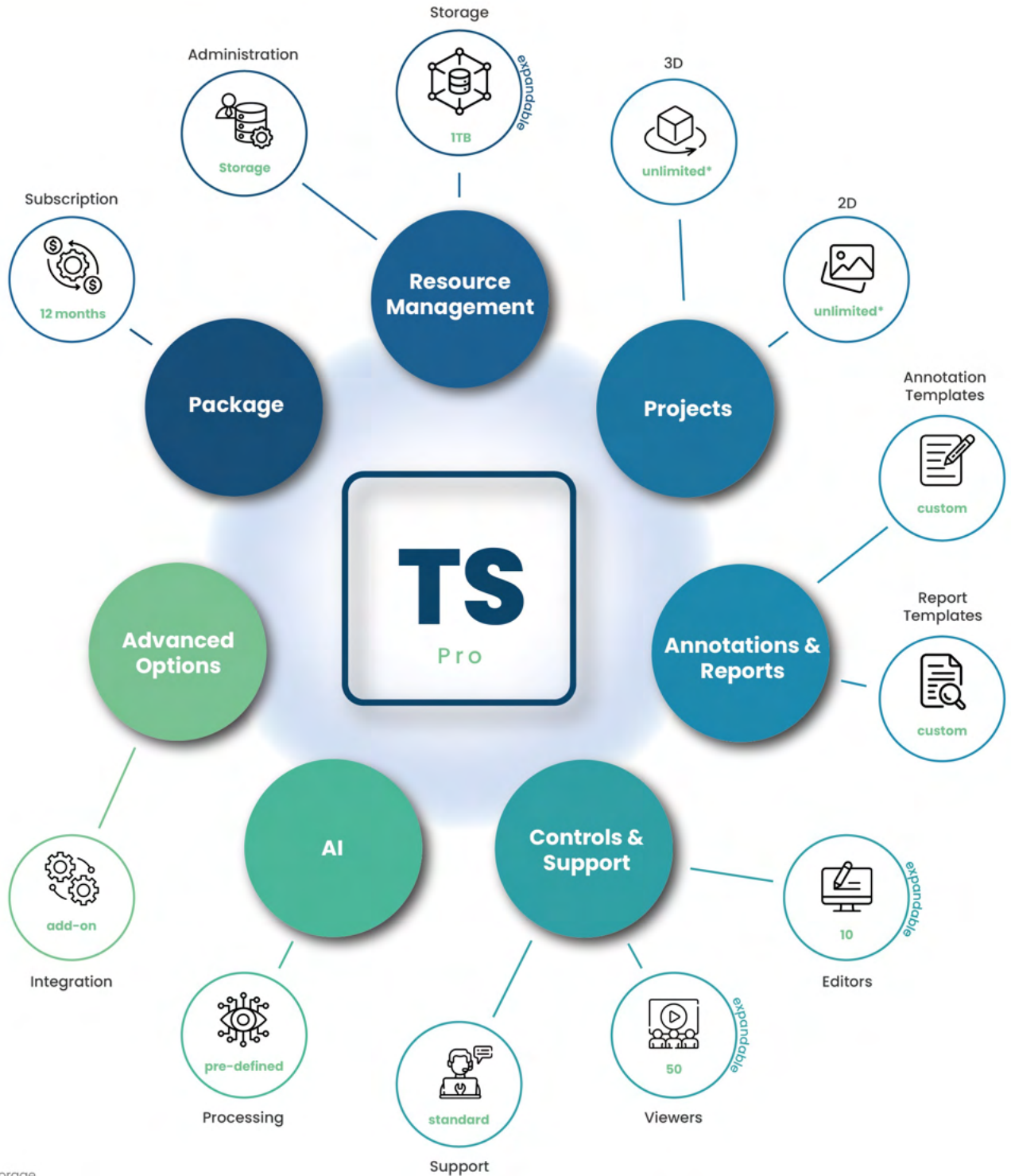

For the Ambitious Power User

Twinspect Pro is for the power user. This package includes increased storage, storage management, the ability to upgrade to greater storage allotment, and increased number of editors and viewers. Additional functionality includes the ability to customize inspection criteria and reporting for different asset classes and different industries.

Twinspect Enterprise

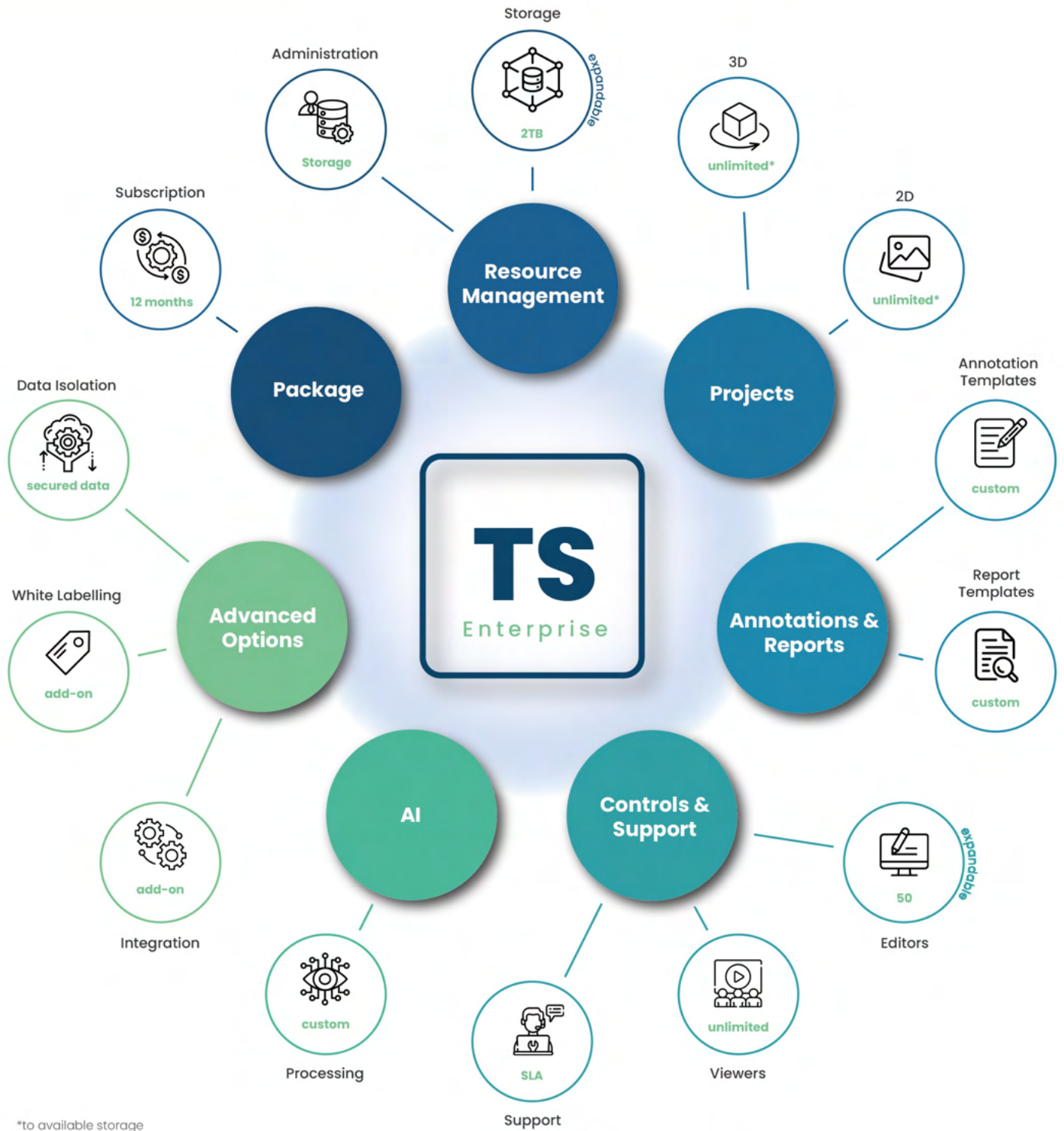

Ultimate Flexibility for Organizations

Unlock full autonomy and limitless scalability with Twinspect Enterprise, the modular solution for complete organizational deployments. This secure, isolated environment offers seamless integration, customizable AI models, white-labeling options, and unlimited viewers, empowering you to tailor inspections, streamline workflows, and maximize value across your entire organization.

Workflow

Data Acquisition

We support various types of visual drone images (RGB, NR, MSP)



Data Processing

Integrate your external 3D mesh models in OBJ format from leading photogrammetry solutions.

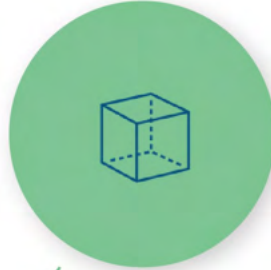

Data Upload to TWINSPECT

Unlock the power of your 3D and 2D inspection data on our platform.



Analysis of Defects & Actions

AI-assisted defect detection and visual documentation for expert teams.



Automated Reporting

High-quality PDF reports can be exported for documentation and maintenance planning.

Organize and Share Data

Easy access and sharing of 3D models and inspection data with all stakeholders via web browser.



OUR FEATURES IN DETAIL

2D Projects



No 3D model? No problem with Twinspect. Our solution supports image-only 2D projects, enabling you to conduct visual analysis by marking damages and taking measurements directly on the images. Any marked damages or measurements are automatically displayed across all related images. While navigation and filtering through a 3D model are not available in this context, users can efficiently organize, view, inspect, and annotate raw images.

3D Projects



Our 3D projects enable detailed visual analysis by marking damages and taking measurements within images and the 3D model. Any marked damages or measurements are automatically displayed across all related images and within the 3D model. The original images and the model are intelligently interconnected, allowing users to filter and display associated images by double-clicking a point in the model.

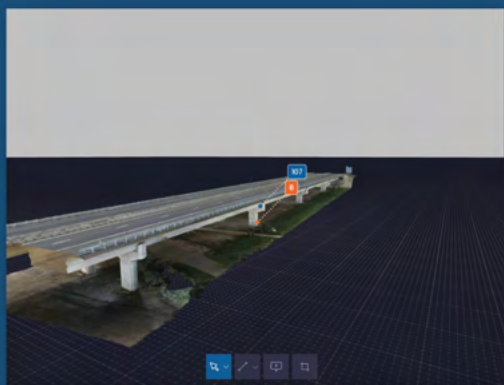

AI Module



Harness the power of our proprietary deep learning algorithms with the AI Module. It sorts damages by probability, displayed as a percentage, and allows for manual verification to confirm findings before integration. This module can also be trained based on manual verifications, enhancing its accuracy over time. The Pro level features our pre-defined models, which will continue to grow, while the Enterprise level offers the flexibility to use personalized, customized modules tailored to your specific needs.

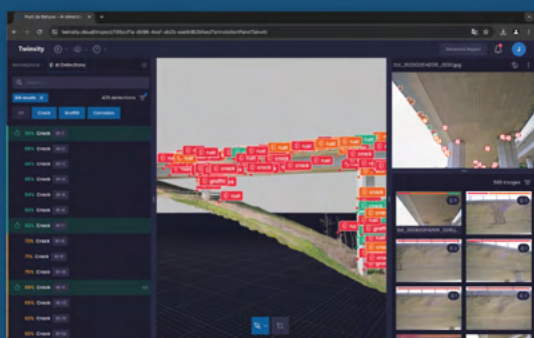

Data Isolation



Ensure the highest level of data security with Twinspect. Our isolation options provide peace of mind, offering regionalized and localized data storage for our Enterprise customers. All customers benefit from Twinsity's ISO 27001 certification, ensuring robust data security and protection standards. Rest assured, your data is safe with Twinspect.

Annotation & Report Templates

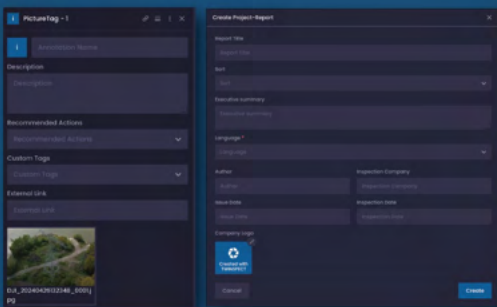













Our annotation templates include everything essential for documenting damages, with a standard configuration available in every package. These templates can be individually modified and customized on our Pro & Enterprise level subscriptions. Similarly, the report template displays all annotations made in the project, along with their corresponding information, in a standard design.

Editors / Viewers



Editors have full access to all functions necessary for inspecting the respective project. They can modify project settings and utilize inspection tools. Viewers, on the other hand, have complete access to view all annotations, measurements, and navigate through the 3D model. However, they are restricted from modifying project settings or using inspection tools in this mode.

Comparison

	Lite	Pro	Enterprise
 Storage Allocation { Included Expandable	0.25 TB X	1 TB ✓	2 TB ✓
 Storage Administration	✓	✓	✓
 2D (images only)	Unlimited*	Unlimited*	Unlimited*
 3D	Unlimited*	Unlimited*	Unlimited*
 Annotation Templates { Pre-Defined Custom	✓ X	✓ ✓	✓ ✓
 Report Templates { Pre-Defined Custom	✓ X	✓ ✓	✓ ✓
 Editors { Included Expandable	5 X	10 ✓	50 ✓
 Viewers { Included Expandable	20 X	50 ✓	Unlimited Unlimited
 Support	Standard	Standard	SLA
 AI Module { Pre-Defined Custom	X X	✓ X	✓ ✓
 Data Isolation	X	X	✓
 White Labelling	X	X	Optional Add-On
 Integration	X	Optional Add-On	Optional Add-On

*to available storage

We would be pleased to offer you detailed pricing information on the individual product pages or provide personalized assistance upon request.

—> —> —> info@twinsity.com <— <— <—